

# NOBLIFT EDGE

## Electric Pallet Truck PTE15N (540)



Surface of Forks can lift from 80mm to 195mm.



Support wheel for downhill or uphill.



- Smart battery positioning and lock for great fixation and safety.
- Socket on battery case for easy battery charging without necessity to take the battery out.
- Fast and opportunity charging during brakes in operations increases working time.



Strong steel apron protects the operator's feet during work and secures the truck's components from collisions with objects.



Full length double sided C-shape reinforcements of forks significantly increase strength and rigidity of frame.

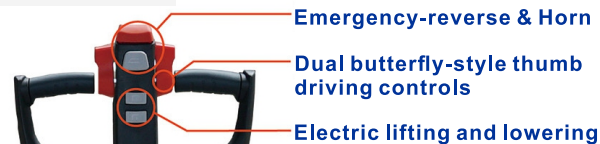
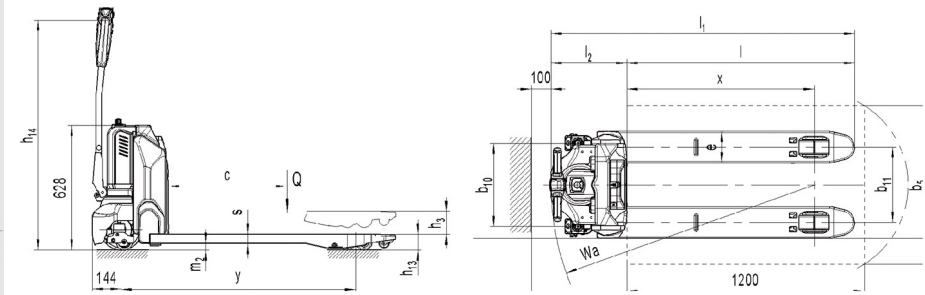

General	1.20	Model		PTE15N (540)
	1.30	Drive		Battery
	1.50	Load Capacity	Q(kg)	1500
Weight	2.10	Total Weight (with Battery)		kg 123
Tyres	3.10	Tires		Polyurethane (PU)
	3.20	Tire Size	Front	ø x w (mm) ø210 x 70
	3.30		Rear	ø x w (mm) ø80 x 70
	3.40		Additional	ø x w (mm) ø80 x 30
Dimensions	4.90	Height of Tiller (in drive position)	Min. / Max.	h <sub>14</sub> (mm) 700 / 1160
	4.15	Height, lowered	h <sub>13</sub> (mm)	80
	4.19	Overall length	l <sub>1</sub> (mm)	1530
	4.21	Overall width	b <sub>1</sub> (mm)	540
	4.22	Fork dimensions	s / e / l (mm)	47 / 160 / 1150
	4.25	Distance between fork-arms	b <sub>5</sub> (mm)	540
	4.34	Aisle width for pallets 800 X 1200 lengthways (200mm safe distance)	Ast (mm)	2000
	4.35	Turning radius	Wa (mm)	1330
Performance	5.10	Travel speed	Laden / Unladen	km/h 4.6 / 4.8
	5.20	Lift speed	Laden / Unladen	m/s 0.020 / 0.025
	5.30	Lowering speed	Laden / Unladen	m/s 0.05 / 0.04
	5.80	Max. gradeability	Laden / Unladen	% 4° / 16°
Electric-engine	6.10	Drive motor rating S2 60min		kW 0.65
	6.20	Lift motor rating at S3 10%		kW 0.50
	6.40	Battery voltage, nominal capacity K5		V / Ah 24 / 20
	6.50	Battery Weight		kg 4.6
Other	8.40	Sound level at driver's ear acc. To EN 12053		dB (A) <70