

## Guide rollers



## Table of Contents

	<p><b>FTH</b></p> <p>Series FTH  Wheel Ø 30 - 75 mm  Load capacity 20 - 125 kg</p> <p><b>Page 430</b></p>
	<p><b>FSTH</b></p> <p>Series FSTH  Wheel Ø 40 - 125 mm  Load capacity 45 - 330 kg</p> <p><b>Page 431</b></p>
	<p><b>FPOB</b></p> <p>Series FPOB  Wheel Ø 80 - 125 mm  Load capacity 130 - 300 kg</p> <p><b>Page 432</b></p>
	<p><b>FPTH</b></p> <p>Series FPTH  Wheel Ø 60 - 125 mm  Load capacity 110 - 290 kg</p> <p><b>Page 433</b></p>
	<p><b>FPU</b></p> <p>Series FPU  Wheel Ø 25 - 60 mm  Load capacity 20 - 120 kg</p> <p><b>Page 434</b></p>
	<p><b>FPO</b></p> <p>Series FPO  Wheel Ø 25 - 125 mm  Load capacity 30 - 400 kg</p> <p><b>Page 435</b></p>

Series: FTH

## Guide rollers with Blickle Extrathane® polyurethane tread

20 - 125 kg

RoHS



<b>Tread &amp; tyre hardness</b>	92° shore A
<b>Temperature resistance</b>	-25° C - +70° C temporarily up to +90° C
<b>Rolling resistance</b>	very good
<b>Operating noise</b>	good
<b>Floor surface preservation</b>	good



### FTH-guide roller series:

**Tread:** Made of high-quality, reaction-injected polyurethane-elastomer Blickle Extrathane®, 92° shore A hardness, low-noise operation, low rolling resistance, good floor preservation, high abrasion resistance, high cut and tear propagation resistance, colour light brown, non-marking, non-staining, tread directly bonded onto the ball bearing, very good chemical connection. (Material description page 39)

### Bearing type:

- Ball bearing, sealed, lubricated with long-life grease

### Other features:

High chemical resistance to many aggressive substances (table page 36-37).

Operating temperature: -25° C to +70° C, temporarily up to +90° C.

At ambient temperatures above +40° C the load capacity is reduced.

The load capacities indicated refer to applications without obstacles.

Maintenance-free under standard conditions.

**Wheel series overview page 53**

Guide rollers	Wheel Ø (D) [mm]	Wheel width (T2) [mm]	Load capacity [kg]	Ball bearing	Axle bore Ø (d) [mm]	Clamping length (T5) [mm]
FTH 30x8/6-6K	30	8	20	626 2RS	6	6
FTH 30x11/9-7K	30	11	30	609 2RS	9	7
FTH 30x14/5-12K	30	14	40	2 x 635 2RS	5	12
FTH 34x16/8-7K	34	16	30	608 2RS	8	7
FTH 35x14/12-8K	35	14	40	6001 2RS	12	8
FTH 36x13/10-9K	36	13	40	6200 2RS	10	9
FTH 40x15/10-8K	40	15	40	6000 2RS	10	8
FTH 40x20/10-9K	40	20	50	6200 2RS	10	9
FTH 45x17/15-11K	45	17	70	6202 2RS	15	11
FTH 50x15/10-9K	50	15	60	6200 2RS	10	9
FTH 50x15/12-12K	50	15	70	6301 2RS	12	12
FTH 50x18/15-11K	50	18	70	6202 2RS	15	11
FTH 52x15/12-12K	52	15	70	6301 2RS	12	12
FTH 60x20/17-12K	60	20	90	6203 2RS	17	12
FTH 61x30/17-12K	61	30	95	6203 2RS	17	12
FTH 62x15/20-12K	62	15	85	6004 2RS	20	12
FTH 70x20/25-15K	70	20	125	6205 2RS	25	15
FTH 75x23/20-14K	75	23	110	6204 2RS	20	14

Further dimensions upon request

### Options



With stainless steel ball bearing

Technical description page

61

Product code suffix

-XK

Available for

upon request

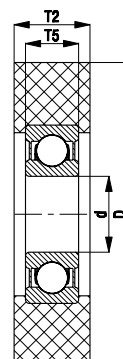

Series: FSTH

## Guide rollers with Blickle Extrathane® polyurethane tread, with steel wheel centre

45 - 330 kg

RoHS



<b>Tread &amp; tyre hardness</b>	92° shore A
<b>Temperature resistance</b>	-25° C - +70° C temporarily up to +90° C
<b>Rolling resistance</b>	very good
<b>Operating noise</b>	good
<b>Floor surface preservation</b>	good



### FSTH-guide roller series:

**Tread:** Made of high-quality, reaction-injected polyurethane-elastomer Blickle Extrathane®, 92° shore A hardness, low-noise operation, low rolling resistance, good floor preservation, high abrasion resistance, high cut and tear propagation resistance, colour light brown, non-marking, non-staining, very good chemical connection with the wheel centre.

(Material description page 39)

**Wheel centre:** Made of steel.

### Bearing type:

- Ball bearing, sealed, lubricated with long-life grease

### Other features:

High chemical resistance to many aggressive substances (table page 36-37).

Operating temperature: -25° C to +70° C, temporarily up to +90° C.

At ambient temperatures above +40° C the load capacity is reduced.

The load capacities indicated refer to applications without obstacles.

Maintenance-free under standard conditions.

**Wheel series overview page 53**

Guide rollers	Wheel Ø (D) [mm]	Wheel width (T2) [mm]	Load capacity [kg]	Ball bearing	Axle bore Ø (d) [mm]	Clamping length (T5) [mm]
FSTH 40x13/10-8K	40	13	45	6000 2RS	10	8
FSTH 40x15/10-8K	40	15	55	6000 2RS	10	8
FSTH 40x20/10-8K	40	20	70	6000 2RS	10	8
FSTH 40x25/10-8K	40	25	90	6000 2RS	10	8
FSTH 50x15/10-8K	50	15	65	6000 2RS	10	8
FSTH 50x18/17-10K	50	18	80	6003 2RS	17	10
FSTH 50x25/12-10K	50	25	110	6201 2RS	12	10
FSTH 55x20/15-11K	55	20	95	6202 2RS	15	11
FSTH 60x20/15-13K	60	20	105	6302 2RS	15	13
FSTH 60x20/20-12K	60	20	105	6004 2RS	20	12
FSTH 60x25/20-12K	60	25	130	6004 2RS	20	12
FSTH 68x20/15-13K	68	20	120	6302 2RS	15	13
FSTH 70x20/20-12K	70	20	125	6004 2RS	20	12
FSTH 70x25/20-15K	70	25	155	6304 2RS	20	15
FSTH 70x25/25-15K	70	25	155	6205 2RS	25	15
FSTH 75x25/20-15K	75	25	165	6304 2RS	20	15
FSTH 75x25/25-15K	75	25	165	6205 2RS	25	15
FSTH 80x20/20-14K	80	20	140	6204 2RS	20	14
FSTH 80x25/20-15K	80	25	180	6304 2RS	20	15
FSTH 80x25/25-15K	80	25	180	6205 2RS	25	15
FSTH 90x25/20-15K	90	25	200	6304 2RS	20	15
FSTH 90x25/25-15K	90	25	200	6205 2RS	25	15
FSTH 100x25/20-15K	100	25	220	6304 2RS	20	15
FSTH 100x25/25-15K	100	25	220	6205 2RS	25	15
FSTH 110x25/25-15K	110	25	240	6205 2RS	25	15
FSTH 120x25/25-15K	120	25	265	6205 2RS	25	15
FSTH 125x25/25-15K	125	25	275	6205 2RS	25	15
FSTH 125x30/20-15K	125	30	330	6304 2RS	20	15
FSTH 125x30/25-15K	125	30	330	6205 2RS	25	15

Further dimensions upon request



### Options

Further versions

Technical description page

Product code suffix

Available for upon request

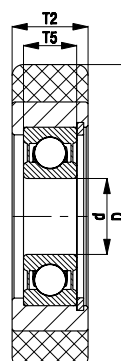

Series: FPOB

## Guide rollers with Blickle Besthane® polyurethane tread, with nylon wheel centre

130 - 300 kg

RoHS



<b>Tread &amp; tyre hardness</b>	92° shore A
<b>Temperature resistance</b>	-25° C - +70° C
<b>Rolling resistance</b>	excellent
<b>Operating noise</b>	good
<b>Floor surface preservation</b>	good



### FPOB-guide roller series:

**Tread:** Made of high-quality, reaction-injected polyurethane-elastomer Blickle Besthane®, 92° shore A hardness, low-noise operation, very low rolling resistance, **high dynamic load capacity**, good floor preservation, high abrasion resistance, high cut and tear propagation resistance, **hydrolysis resistant**, colour brown, non-marking, non-staining, very good chemical connection with the wheel centre.  
(Material description page 39)

**Wheel centre:** Made of high-quality, impact-resistant nylon, colour black.

#### Bearing type:

- Ball bearing, sealed, lubricated with long-life grease

#### Other features:

High chemical resistance to many aggressive substances (table page 36-37).  
Operating temperature: -25° C to +70° C.  
At ambient temperatures above +40° C the load capacity is reduced.  
The load capacities indicated refer to applications without obstacles.  
Maintenance-free under standard conditions.  
**Wheel series overview page 53**

Guide rollers	Wheel Ø	Wheel width	Load cap. at 4 km/h	Load cap. at 10 km/h	Ball bearing	Axle bore Ø (d) [mm]	Clamping length (T5) [mm]
	(D) [mm]	(T2) [mm]	[kg]	[kg]			
<b>FPOB 80x20/20-14K</b>	80	20	130	100	6204 2RS	20	14
<b>FPOB 100x25/25-15K</b>	100	25	200	160	6205 2RS	25	15
<b>FPOB 125x30/25-15K</b>	125	30	300	250	6205 2RS	25	15

Further dimensions upon request

### Options



With stainless steel ball bearing

Technical description page	61
<b>Product code suffix</b>	<b>-XK</b>
Available for	upon request

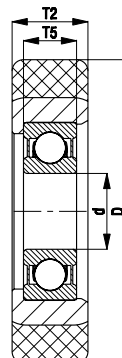

Series: FPTH

## Guide rollers with thermoplastic polyurethane tread, with nylon wheel centre

110 - 290 kg

RoHS



<b>Tread &amp; tyre hardness</b>	92° shore A
<b>Temperature resistance</b>	-25° C - +70° C temporarily up to +90° C
<b>Rolling resistance</b>	very good
<b>Operating noise</b>	good
<b>Floor surface preservation</b>	good

### FPTH-guide roller series:

**Tread:** Made of high-quality thermoplastic polyurethane, 92° shore A hardness, low-noise operation, low rolling resistance, good floor preservation, high abrasion resistance, **hydrolysis resistant**, colour dark grey, non-marking, non-staining, chemically bonded for an inseparable connection with the wheel centre.

(Material description page 39)

**Wheel centre:** Made of high-quality, impact-resistant nylon, colour silver grey.

### Bearing type:

- Ball bearing, sealed, lubricated with long-life grease

### Other features:

Very high chemical resistance to many aggressive substances (table page 36-37).

Operating temperature: -25° C to +70° C, temporarily up to +90° C.

At ambient temperatures above +35° C the load capacity is reduced.

The load capacities indicated refer to applications without obstacles.

Maintenance-free under standard conditions.

**Wheel series overview page 54**

Guide rollers	Wheel Ø (D) [mm]	Wheel width (T2) [mm]	Load capacity [kg]	Ball bearing	Axle bore Ø (d) [mm]	Clamping length (T5) [mm]
FPTH 60x20/17-12K	60	20	110	6203 2RS	17	12
FPTH 70x20/25-15K	70	20	130	6205 2RS	25	15
FPTH 70x25/20-14K	70	25	160	6204 2RS	20	14
FPTH 80x20/15-11K	80	20	150	6202 2RS	15	11
FPTH 80x20/17-14K	80	20	150	6303 2RS	17	14
FPTH 80x20/20-14K	80	20	150	6204 2RS	20	14
FPTH 80x25/25-12K	80	25	180	6005 2RS	25	12
FPTH 100x25/25-15K	100	25	230	6205 2RS	25	15
FPTH 125x25/25-15K	125	25	290	6205 2RS	25	15

Further dimensions upon request

### Options

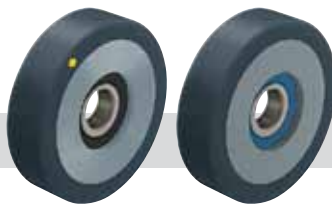

	Electrically conductive version, non-marking	With stainless steel ball bearing
Technical description page	36, 39	61
<b>Product code suffix</b>	<b>-ELS</b>	<b>-XK</b>
Available for	upon request	upon request

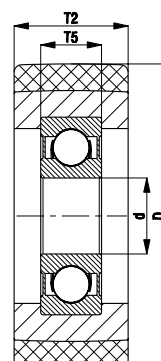

Series: FPU

## Guide rollers with thermoplastic polyurethane tread

20 - 120 kg

RoHS



<b>Tread &amp; tyre hardness</b>	98° shore A
<b>Temperature resistance</b>	-25° C - +70° C temporarily up to +90° C
<b>Rolling resistance</b>	excellent
<b>Operating noise</b>	reasonable
<b>Floor surface preservation</b>	reasonable

### FPU-guide roller series:

**Tread:** Made of high-quality thermoplastic polyurethane, 98° shore A hardness, very low rolling resistance, high abrasion resistance, colour dark brown, non-marking, non-staining, tread directly injected onto the ball bearing.

(Material description page 39)

### Bearing type:

- Ball bearing, sealed, lubricated with long-life grease

### Other features:

High chemical resistance to many aggressive substances (table page 36-37).

Operating temperature: -25° C to +70° C, temporarily up to +90° C.

At ambient temperatures above +35° C the load capacity is reduced.

The load capacities indicated refer to applications without obstacles.

Maintenance-free under standard conditions.

**Wheel series overview page 54**

Guide rollers	Wheel Ø (D) [mm]	Wheel width (T2) [mm]	Load capacity [kg]	Ball bearing	Axle bore Ø (d) [mm]	Clamping length (T5) [mm]
FPU 25x10/6-6K	25	10	20	626 2RS	6	6
FPU 30x8/6-6K	30	8	20	626 2RS	6	6
FPU 30x11/8-7K	30	11	30	608 2RS	8	7
FPU 35x11/8-7K	35	11	30	608 2RS	8	7
FPU 40x16/12-10K	40	16	50	6201 2RS	12	10
FPU 40x20/10-9K	40	20	65	6200 2RS	10	9
FPU 50x15/10-9K	50	15	60	6200 2RS	10	9
FPU 50x15/12-10K	50	15	60	6201 2RS	12	10
FPU 50x20/15-11K	50	20	70	6202 2RS	15	11
FPU 50x25/15-11K	50	25	100	6202 2RS	15	11
FPU 60x20/17-12K	60	20	100	6203 2RS	17	12
FPU 60x25/15-13K	60	25	120	6302 2RS	15	13
FPU 60x25/20-12K	60	25	120	6004 2RS	20	12

Further dimensions upon request

### Options



	Electrically conductive version, non-marking	With stainless steel ball bearing
Technical description page	36, 39	61
Product code suffix	-ELS	-XK
Available for	upon request	upon request

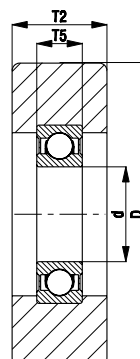

Series: FPO

## Guide rollers with nylon tread

30 - 400 kg

RoHS



<b>Tread &amp; tyre hardness</b>	70° shore D
<b>Temperature resistance</b>	-25° C - +80° C
<b>Rolling resistance</b>	excellent
<b>Operating noise</b>	reasonable
<b>Floor surface preservation</b>	reasonable

### FPO-guide roller series:

**Tread:** Made of high-quality, impact-resistant nylon, 70° shore D hardness, very low rolling resistance, smooth running performance on even floors, high abrasion resistance, colour natural white, tread directly injected onto the ball bearing. (Material description page 40)

### Bearing type:

- Ball bearing, sealed, lubricated with long-life grease

### Other features:

High chemical resistance to many aggressive substances (table page 36-37).

Operating temperature: -25° C to +80° C.

At ambient temperatures above +35° C the load capacity is reduced.

The load capacities indicated refer to applications without obstacles.

Maintenance-free under standard conditions.

**Wheel series overview page 54**

Guide rollers	Wheel Ø (D) [mm]	Wheel width (T2) [mm]	Load capacity [kg]	Ball bearing	Axle bore Ø (d) [mm]	Clamping length (T5) [mm]
FPO 25x10/6-6K	25	10	30	626 2RS	6	6
FPO 30x8/6-6K	30	8	35	626 2RS	6	6
FPO 30x11/8-7K	30	11	40	608 2RS	8	7
FPO 35x11/8-7K	35	11	55	608 2RS	8	7
FPO 40x16/12-10K	40	16	80	6201 2RS	12	10
FPO 40x20/10-9K	40	20	100	6200 2RS	10	9
FPO 50x15/10-9K	50	15	100	6200 2RS	10	9
FPO 50x15/12-10K	50	15	100	6201 2RS	12	10
FPO 50x20/15-11K	50	20	130	6202 2RS	15	11
FPO 50x25/15-11K	50	25	165	6202 2RS	15	11
FPO 60x20/17-12K	60	20	165	6203 2RS	17	12
FPO 60x25/15-13K	60	25	200	6302 2RS	15	13
FPO 60x25/20-12K	60	25	200	6004 2RS	20	12
FPO 70x20/25-15K	70	20	185	6205 2RS	25	15
FPO 70x25/20-14K	70	25	225	6204 2RS	20	14
FPO 80x20/15-11K	80	20	210	6202 2RS	15	11
FPO 80x20/17-14K	80	20	210	6303 2RS	17	14
FPO 80x20/20-14K	80	20	210	6204 2RS	20	14
FPO 80x25/25-12K	80	25	265	6005 2RS	25	12
FPO 100x25/25-15K	100	25	330	6205 2RS	25	15
FPO 125x25/25-15K	125	25	400	6205 2RS	25	15

Further dimensions upon request

### Options



	Electrically conductive version, non-marking grey	With stainless steel ball bearing
Technical description page	36, 40	61
Product code suffix	-ELS	-XK
Available for	upon request	upon request

